

7CI100A



7FS100A



**Following installation, please forward this manual  
to the appropriate operations person.**

# Contents

---

<b>Welcome</b>	<b>3</b>
<b>Before You Begin</b>	<b>3</b>
<b>Important Safety Information</b>	<b>3</b>
<b>Specifications</b>	<b>4</b>
Dimensions	4
Ambient Information	4
Plumbing	4
Water	4
Clearances	4
Electrical	4
Refrigeration	4
Heat Rejection	4
Detailed Drawing	5
<b>Installation</b>	<b>6</b>
Countertop Installation	6
Freestanding Installation	8
<b>Maintenance/Cleaning Mode</b>	<b>11</b>
<b>Accessing Internal Components</b>	<b>11</b>
<b>Filter Display Indicator Activation</b>	<b>12</b>
<b>Cleaning and Sanitizing</b>	<b>13</b>
<b>Service</b>	<b>14</b>
LED Indicator Description	14
Water Feed Schematic	15
Bin Melt Water/Evaporator Feed/Clean Out System Schematic	16
Vent System Schematic	16
Refrigeration Schematic	17
Condenser Fan Motor Removal	18
User Interface Display Identification	19
Electrical Wiring Diagram	21
<b>Parts</b>	<b>22</b>
Exterior	22
Interior	24
Bin Assembly	26
Evaporator Assembly	28
Base Stand	30

## Welcome

Follett equipment enjoys a well-deserved reputation for excellent performance, long-term reliability, and outstanding after-the-sale support. To ensure that this product delivers that same degree of service, we ask that you take a moment to review this manual before beginning the installation. Should you have any questions or require technical help at any point, please call our technical service group at (877) 612-5086 or +1 (610) 252-7301.

## Before You Begin

After uncrating and removing all packing material, inspect the equipment for concealed shipping damage. If damage is found, immediately notify the shipper and contact Follett Corporation so that we can help in the filing of a claim, if necessary. If needed, the serial number of your dispenser can be found by removing the drip tray (1) and locating the serial number label (2).

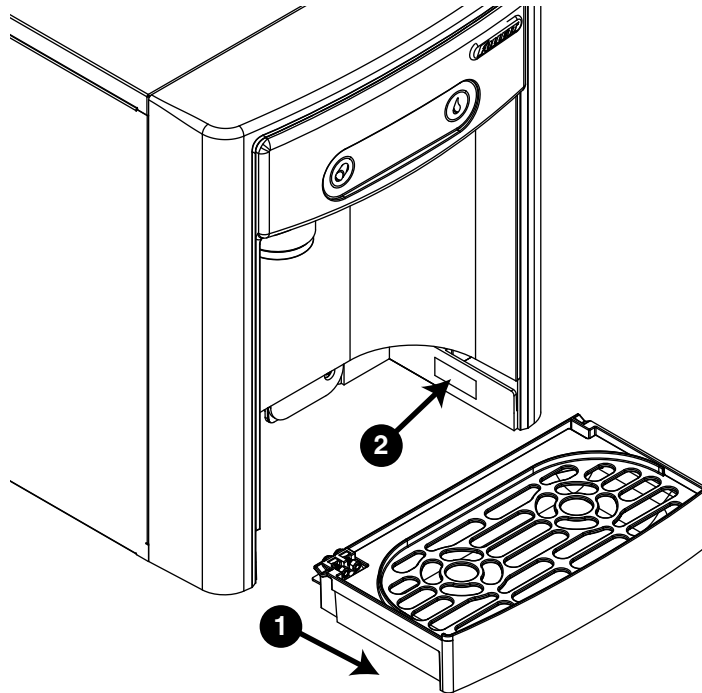

Check your paperwork to verify that you received the correct dispenser. Follett configuration numbers are designed to provide information about the type of dispenser you are receiving. The following is an explanation of the different model numbers.

Dispenser Storage Capacity	Configuration	Icemaker Capacity	Condenser
7 lb	CI FS	100 lb per day	A Air-cooled

## Important Safety Information

Please read and adhere to the following safety information while installing, using, or servicing your Follett 7 Series Ice Dispenser.

1. Always disconnect power before servicing the dispenser.
2. Ice is slippery. Maintain counters and floors around dispenser in a clean and ice-free condition.
3. Ice is food. Follow the recommended cleaning and sanitizing instructions to maintain cleanliness of delivered ice.

# Specifications

## Dimensions

	7CI100A	7FS100A
Width	14.55" (370 mm)	14.55" (370 mm)
Depth	22.05" (560 mm)	22.05" (560 mm)
Height	17.53" (450 mm)	41.93" (1065 mm)
Unit Shipping Weight	90 lb (41 kg)	120 lb (54.4 kg)

## Ambient Information



### CAUTION!

The 7CI100A and 7FS100A are for indoor use only.

	Maximum*	Minimum*
Air Temperature†	100 F (38 C)	50 F (10 C)
Water Temperature	90 F (32.2 C)	40 F (4.5 C)
Water Pressure	70 psi	10 psi
Relative Humidity	55% at 78 F	

\* Use outside of these limitations is misuse and will void warranty.  
† Best performance is achieved between 80 F (27 C) and 50 F (10 C).

## Plumbing

- Water Inlet: 1/4" MPT
- Optional Drain Accessory Kit (item# 00956375): 1/2" ID tubing
- Water Mineral Content: Greater than 5 ppm (mg/l) TDS and less than 400 ppm (mg/l) TDS
- Water shut-off recommended within 10 feet (3 m) of dispenser

## Water

- For use in applications with less than 400 ppm (mg/l) total dissolved solids in water (either naturally occurring or treated with reverse osmosis) and hardness not to exceed 12 grains per gallon (gpg).
- Not recommended for use with softened water

## Clearances

- 3" (77 mm) behind and on each side of dispenser for electrical and connection and ventilation

## Electrical

- 115V, 60 Hz, 1 phase, 5A, maximum fuse 15A
- Connect to dedicated 15A circuit, fuse or breaker
- Must be grounded - requires 3-prong outlet. Do not remove ground.

## Refrigeration

- Refrigerant R134a – 7.2 ounces (204 grams)

## Heat Rejection

- 1700 BTU/hr (498 W)

# Specifications (continued)

## Detailed Drawing

### Countertop models

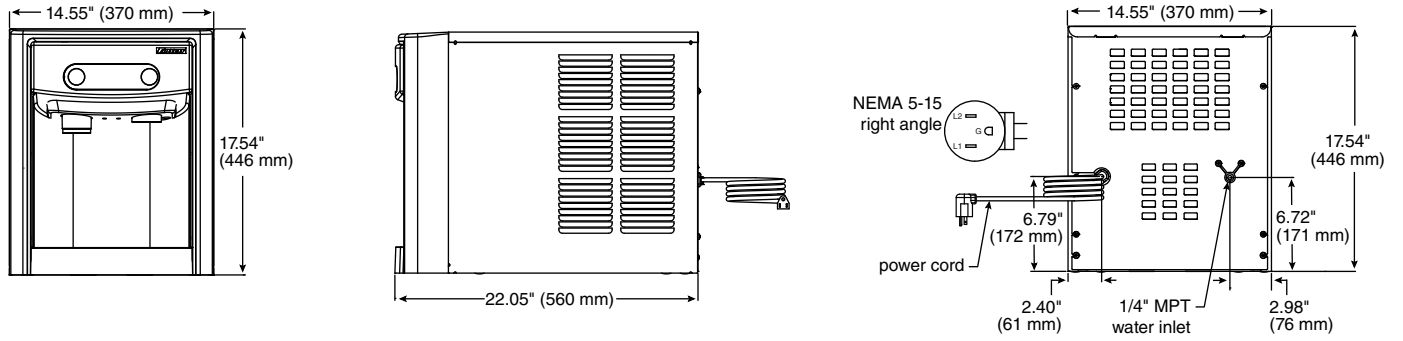

### Freestanding models

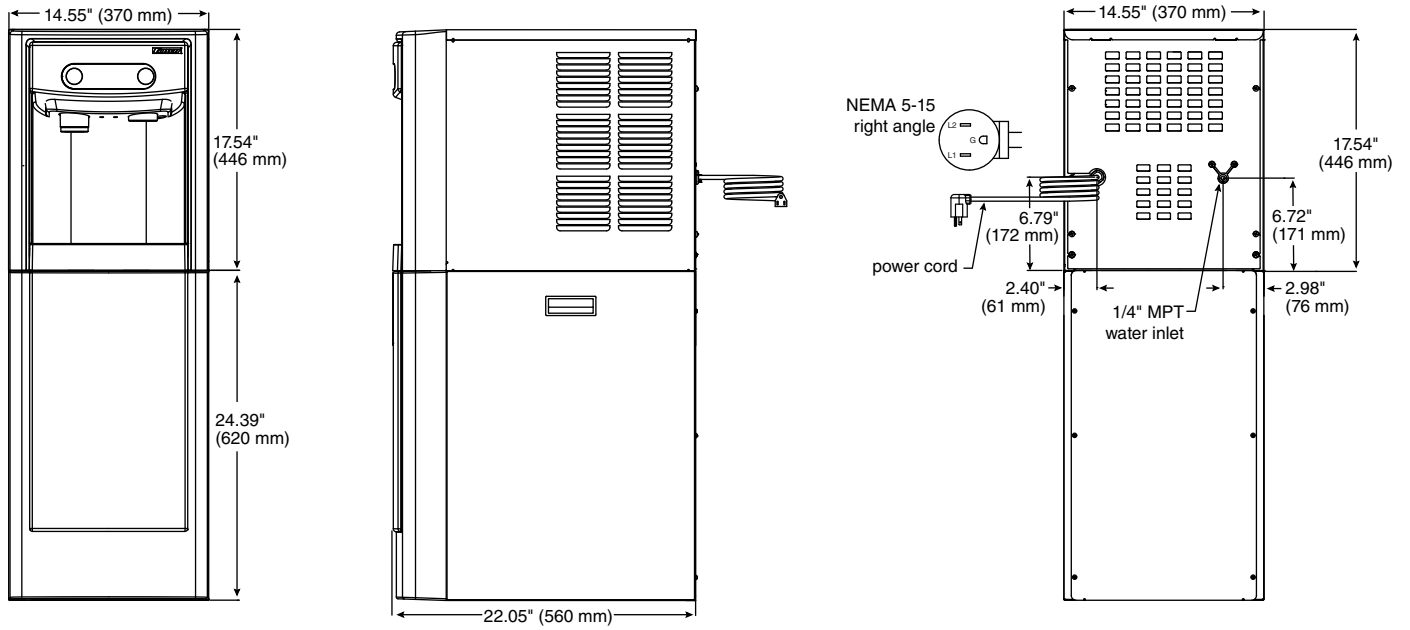

# Installation



## CAUTION!

No service or maintenance should be performed until the technician has thoroughly read this service manual. Except for routine cleaning and sanitizing, only qualified technicians should attempt to service or maintain this equipment.

## Countertop Installation

Installation instructions for freestanding model may be found on [page 8](#).

1. A clearance of at least 3" (77 mm) is required behind and on each side of the dispenser for electrical connection and ventilation (**Fig. 1**).
2. Rough-in the electrical service and water line.
  - Electrical: 115V, single phase, 15A receptacle required. The dispenser has an integral 8 ft. (2.4 m) cord and plug.
  - Water: supply line (with shut-off valve) connects to the dispenser's 1/4" MPT inlet.

## NOTICE!

If installing optional Drip Tray Drain Kit or Leg Accessory, complete those steps before proceeding.

3. Connect water line. Recommended routing (**Fig. 2**) allows easy access to water for cleaning and sanitizing procedure.
4. Connect power supply.
5. Sanitize the dispenser prior to use (see [Cleaning and Sanitizing on page 13](#)).

Fig. 1

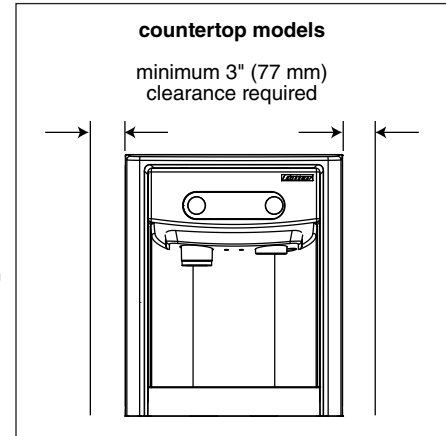
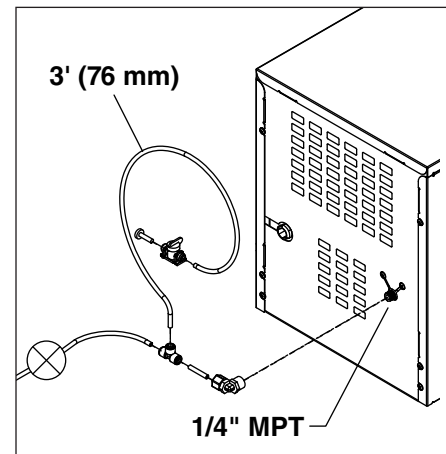

Fig. 2



## Installation (continued)

### Optional Drip Tray Drain Installation

The optional Drip Tray Drain Kit (item# 00956375) requires a floor drain within 15 ft. (4.5 m) of the dispenser. For detailed installation instructions, please refer to the instructions shipped with the Drip Tray Drain Kit.

1. If installing optional Drip Tray Drain Kit, cut hole in countertop for drain tube (**Fig. 3**).

#### **NOTICE!**

*Units without legs must have alternate hole positioning.*

2. Remove drip tray and drill  $1\frac{1}{32}$ " hole through drain nipple (**Fig. 4**).
3. Connect supplied drain tubing to drain tray nipple with supplied hose clamp. Run drain tubing to floor drain.
4. Return tray to original position.

**Fig. 3**

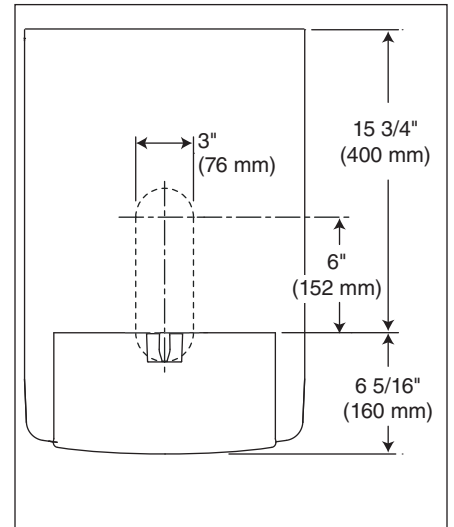

**Fig. 4**

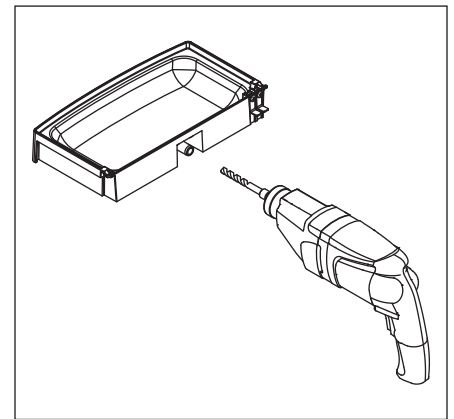

## Installation (continued)

### Optional Leg Accessory Installation

#### CAUTION!

Use caution when tipping the dispenser during leg installation. Do not lay unit on back or side. DO NOT EXCEED 30° angle. Tipping more than 30° can result in compressor malfunction.

1. If installing optional 4" Leg Accessory (item# 00956300), place a 5" (127 mm) spacer underneath the dispenser to ease installation.
2. Remove four plastic, thread-protecting plugs from bottom of dispenser.
3. Screw each leg into chassis (**Fig. 3**).

Fig. 5

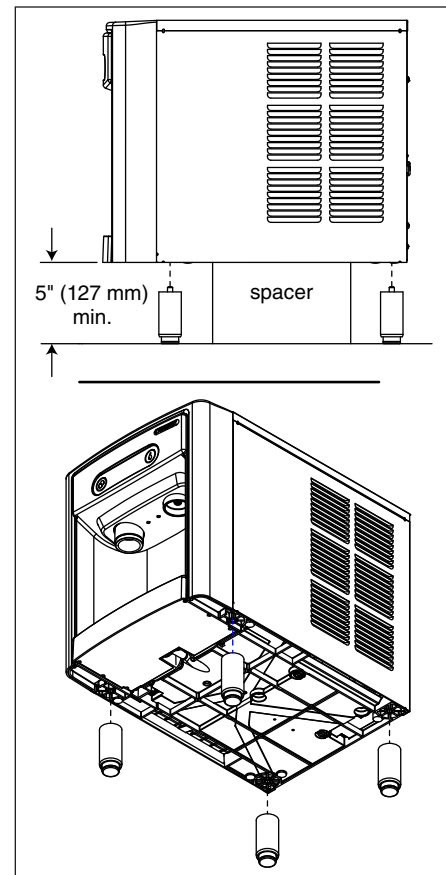

### Freestanding Installation

Installation instructions for countertop model may be found on [Countertop Installation on page 6](#).

1. A clearance of at least 3" (77 mm) is required behind and on each side of the dispenser for electrical connection and ventilation (**Fig. 1**).
2. Rough-in the electrical service and water line.
  - Electrical: 115V, single phase, 15A receptacle required. The dispenser has an integral 8 ft. (2.4 m) cord and plug.
  - Water: supply line (with shut-off valve) connects to the dispenser's 1/4" MPT inlet.

#### NOTICE!

If using Leg Accessory with base stand, complete those steps before proceeding.

Fig. 6

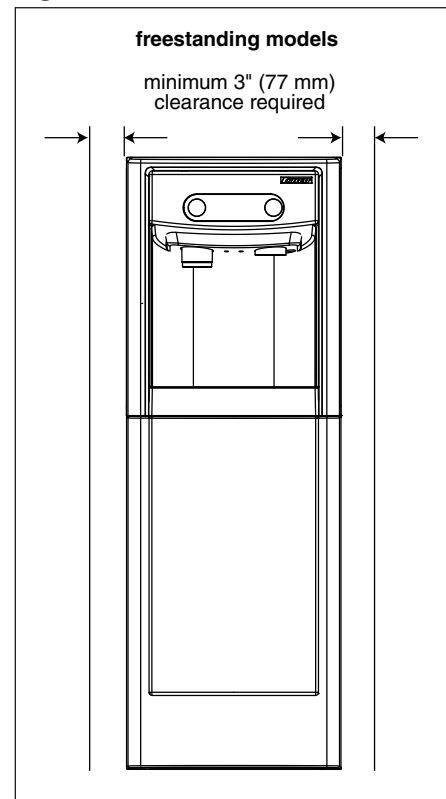



## Installation (continued)

3. Remove four plastic, thread-protecting plugs from bottom of dispenser.
4. Attach dispenser to base stand with supplied hardware (**Fig. 7**).

### NOTICE!

If installing optional Drip Tray Drain Kit, complete those steps before proceeding.

**Fig. 7**

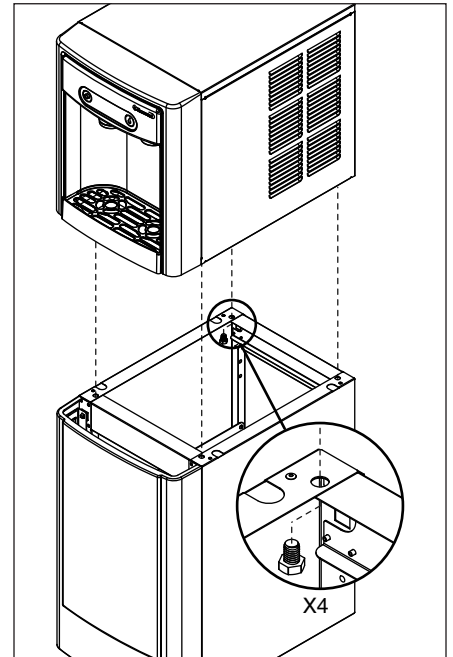

5. Connect water line. Recommended routing (**Fig. 8**) allows easy access to water for cleaning and sanitizing procedure.
6. Connect power supply.
7. Sanitize the dispenser prior to use (see [Cleaning and Sanitizing on page 13](#)).

**Fig. 8**

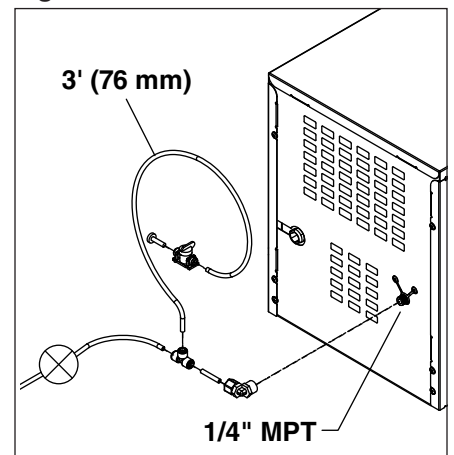

## Installation (continued)

- Secure unit to wall or cove molding with supplied bracket (**Fig. 9**) to prevent tipping.

**Note:** Fasteners must be supplied by installer.



### **WARNING!**

*Freestanding unit must be secured to wall to prevent tipping. Failure to do could result in personal injury or damage to the unit.*

### Optional Leg Accessory Installation

- If installing optional 6" Leg Accessory (item# 00956318), tilt or lay base stand on side and screw each leg into stand (**Fig. 10**).

### Optional Drip Tray Drain Installation

The optional Drip Tray Drain Kit (item# 00956375) requires a floor drain within 15 ft. (4.5 m) of the dispenser. For detailed installation instructions, please refer to the instructions shipped with the Drip Tray Drain Kit.

- If installing optional Drip Tray Drain Kit, remove drip tray and drill 11/32" hole through drain nipple (**Fig. 11**).
- Connect supplied drain tubing to drain tray nipple with supplied hose clamp. Run drain tubing to floor drain.
- Return tray to original position.

**Fig. 9**

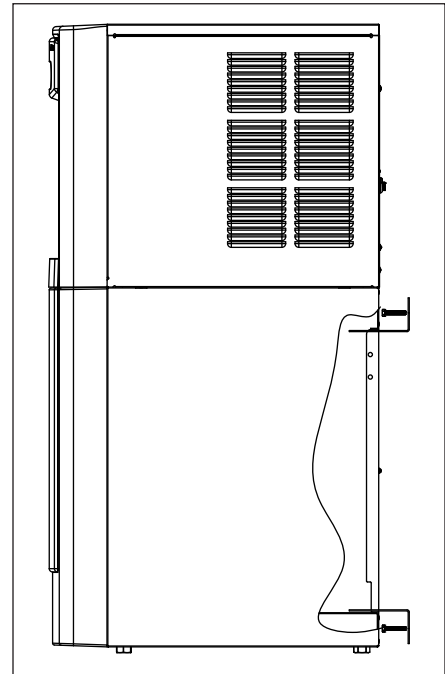

**Fig. 10**

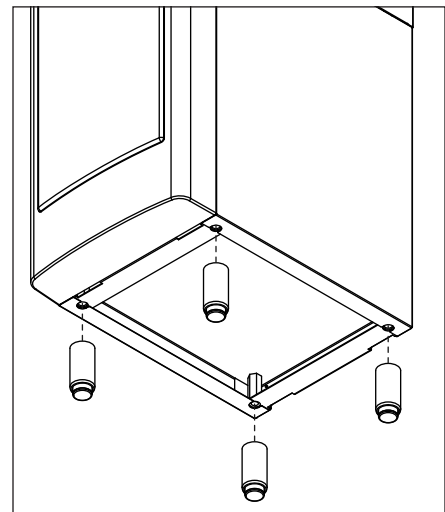

**Fig. 11**

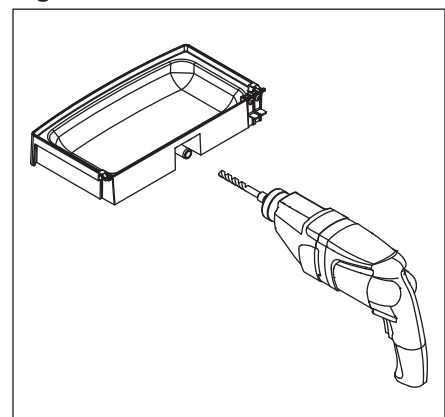

## Maintenance/Cleaning Mode



### Cleaning Mode (Dispensing Disabled) - Use when cleaning surface

Entering Cleaning Mode disables the User Interface and allows you to clean the outside of the dispenser without accidentally dispensing water or ice.

1. To enter Cleaning Mode, press and immediately release the maintenance/clean switch (**Fig. 12.1**) so that only "FRESH FILTERED ICE AND WATER" displays in the user interface (**Fig. 12.2**).
2. To exit Cleaning Mode, press and immediately release the maintenance/clean switch so that the ice and water icons also display in the user interface.

### Maintenance Mode (All Operation Disabled) - Use when cleaning ice machine

Entering Maintenance Mode disables all operations and allows you to safely clean and/or sanitize the icemaker and dispenser.

1. To enter Maintenance Mode, press and hold the maintenance/clean switch (**Fig. 12.3**) until  displays in the user interface (**Fig. 12.4**).
2. To exit Maintenance Mode, press and hold the maintenance/clean switch until  no longer displays in the user interface.

**Note:** Entering and exiting Maintenance Mode will reset the six-month periodic reminder.

Fig. 12

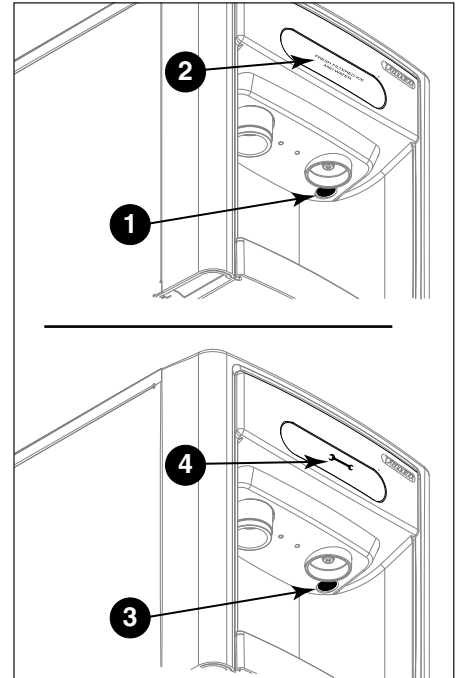

## Accessing Internal Components

### CAUTION!

*Except for routine cleaning and sanitizing, only qualified technicians should attempt to service or maintain this equipment.*

1. Unplug dispenser.
2. Remove (unscrew) chrome ice dispenser chute (**Fig. 13.1**).
3. Remove the drip tray (**Fig. 13.2**).
4. Remove the two screws (**Fig. 13.3**) on the front panel (behind the drip tray).
5. Remove and set aside the front panel (**Fig. 13.4**) - **do not disengage the plug on the back of the User Interface or the tubing at the water dispenser chute (if so equipped).**

Fig. 13

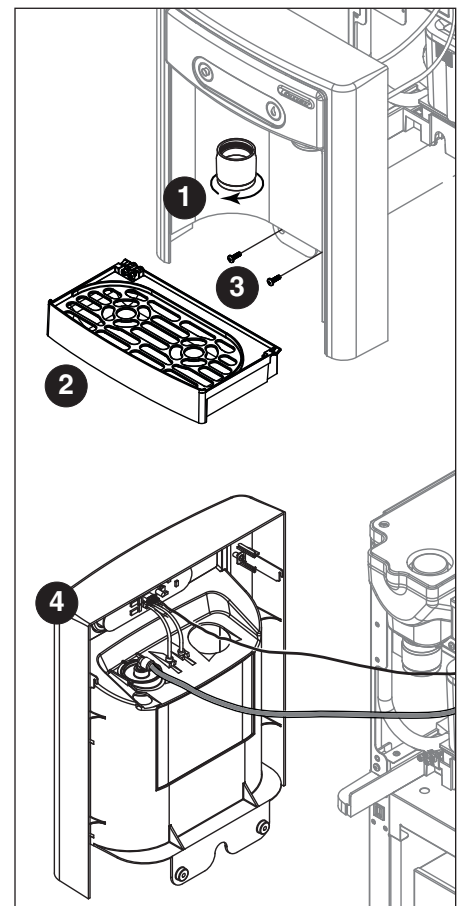

## Filter Display Indicator Activation

If you purchased your dispenser with a Follett filter, the filter display indicator activation has been preset at the factory.

If you are using an “after market filter,” an adjustment may be made to activate the “Fresh Filtered Ice & Water” display.

### Activating “Fresh Filtered Ice & Water”

1. Remove the front panel as explained in [Accessing Internal Components on page 11](#) then refer to **Fig. 14**.
2. Remove top panel (**Fig. 14.1**).
3. Remove (1) screw and top of control board enclosure (**Fig. 14.2**).
4. Locate the DIP switches on the dispenser's control board (**Fig. 15**). Use a fine-pointed object to move the “Filter” DIP switch (DIP switch #3) to the ON position.

### Deactivating the Six-Month Maintenance/Filter Change Reminder

1. Use a fine-pointed object to move the “PM” DIP switch (DIP switch #8) to the ON position.

**Fig. 14**

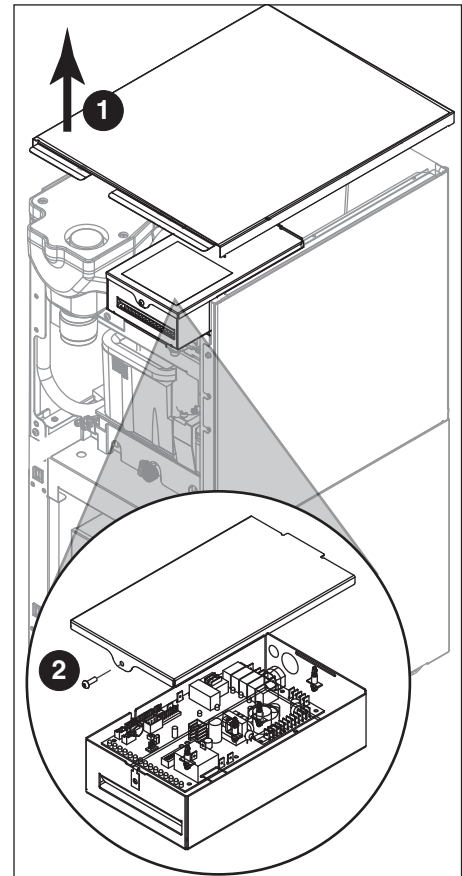

**Fig. 15**

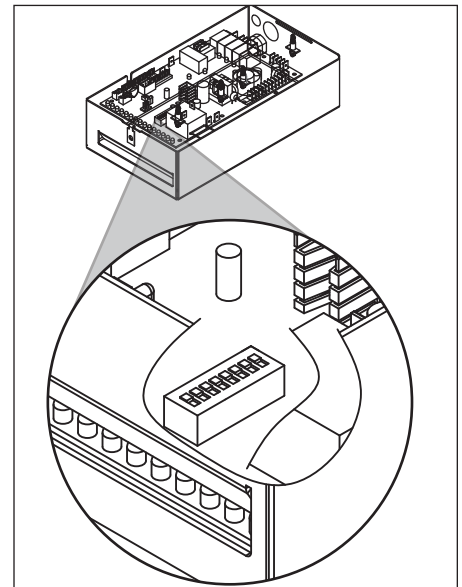

	OFF	ON	
Not used (OFF position)	<input type="checkbox"/>	<input type="checkbox"/>	1
Ice only	<input type="checkbox"/>	<input type="checkbox"/>	2 Ice & water
No internal filter	<input type="checkbox"/>	<input type="checkbox"/>	3 Internal filter supplied or to display "Fresh Filtered"
Not used (OFF position)	<input type="checkbox"/>	<input type="checkbox"/>	4
Not used (OFF position)	<input type="checkbox"/>	<input type="checkbox"/>	5
15 minute delay	<input type="checkbox"/>	<input type="checkbox"/>	6 30 minute delay
Not used (OFF position)	<input type="checkbox"/>	<input type="checkbox"/>	7
Six-month PM enabled	<input type="checkbox"/>	<input type="checkbox"/>	8 Six-month PM disabled

## Cleaning and Sanitizing

Cleaning and sanitizing should be performed at least every 6 months (more often if local water conditions dictate). For initial startup, only sanitizing is required.



### CAUTION!

- Place the dispenser in Maintenance Mode prior to servicing or cleaning the ice machine. See [Maintenance/Cleaning Mode on page 11](#).
- Rubber gloves and safety goggles (and/or face shield) should be worn when handling Cleaner or Sanitizer.
- Do not mix Cleaner and Sanitizer together. It is a violation of federal law to use these solutions in a manner inconsistent with their labeling.
- Do not use bleach.

### Required Supplies

- (3) x 7 oz. SafeCLEAN™ environmentally-friendly icemaker cleaner packets
- Nu-Calgon IMS-II sanitizing concentrate
- Funnel and Bucket

### Cleaning: Icemaker and Dispenser

1. Dispense all the ice out of the unit, then see [Accessing Internal Components on page 11](#).
2. Press and hold maintenance/clean switch until  displays in the user interface to enter Maintenance Mode.
3. Remove (unscrew) chrome ice dispense chute.
4. Remove drip tray.
5. Remove (2) screws located behind the drip tray.
6. Move front panel and place on top or beside unit.
7. Remove plug cap from the end of drain tube and lower tube to drain water into bucket.
8. After the system has been drained of water replace plug cap in drain tube.
9. Secure tube in holder.
10. Remove cap from bin lid cover.
11. Screw cap onto ice discharge chute.
12. Mix SafeCLEAN Ice Machine Cleaner, (3) x 7 oz. packets, with 3 gal. (11.4 L) of water.
13. Pour cleaning solution into bin lid access spout until solution reaches the spout neck.
14. Allow the solution to remain in unit for 15 minutes.
15. While machine is cleaning, remove top and right side panel to access and clean air-cooled condenser.
16. Drain system by lowering drain tube into bucket.
17. Secure drain tube into holder.
18. Fill one time with potable water and drain with fill tube. Secure drain tube.

### Sanitizing: Icemaker and Dispenser

1. Mix a sanitizing solution of 2.5 gal. (9.5 L) of water and 4 oz. (118 ml) of Nu-Calgon IMS-II sanitizing concentrate.
2. Pour sanitizing solution into bin lid access spout until solution reaches the spout neck.
3. Allow the solution to remain in unit for 5 minutes.
4. Drain system by lowering drain tube.
5. Secure drain tube into holder.
6. Fill and drain three times with potable water.
7. Place a bucket under the dispense chute and remove cap. **Caution:** Some sanitizing solution will remain and drain out when cap is removed. Reposition cap on bin lid spout.
8. Reinstall front panel, ice dispense chute, and drip tray.
9. Press and hold maintenance/clean switch to exit Maintenance Mode.

Fig. 16

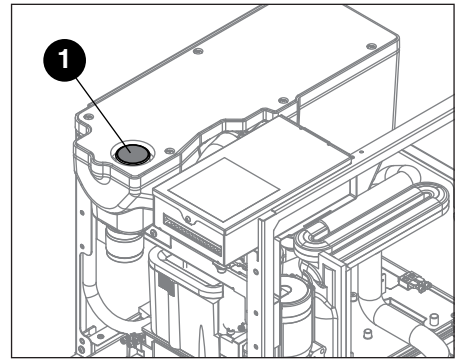

## Cleaning and Sanitizing (continued)

### Cleaning: User Interface and Exterior Cabinet

1. Press and release maintenance/clean switch so that only "FRESH FILTERED ICE AND WATER" displays in the user interface to enter Cleaning Mode (and disable dispensing).
2. Plastic parts, including the user interface, can be cleaned with a non-abrasive glass cleaner. Clean stainless steel panels with stainless steel cleaner.
3. Press and release maintenance/clean switch to put unit back into service.

## Service

### LED Indicator Description

The LED Indicator is located behind the front panel.

Fig. 17



LED Name	LED Color	Description
Clean	Green	The dispenser is in Cleaning Mode. Dispenser is disabled to allow for cleaning of front panel. See <a href="#">Maintenance/Cleaning Mode on page 11.</a>
—	N/A	Not used.
PM	Red	Six-month periodic maintenance required.
Drip tray	Red	Drip tray full.
Water leak	Red	Internal leak in dispenser.
High amps	Red	Auger gearmotor has exceeded 0.55A.
Service	Red	8000 hour bushing check (call Follett technical service group at (877) 612-5086 or +1 (610) 252-7301).
Maintenance	Yellow	Enter Maintenance Mode by pressing and holding maintenance/clean switch for 5 seconds. Unit will not make or dispense ice.
Low water	Yellow	Insufficient water supply to machine or no low bin LED upon startup.
Time delay	Yellow	Ice production will not resume for at least 15 minutes after a full bin is achieved and a minimum amount of dispense activity has elapsed.
Sleep cycle	Green	After a full bin and 10 minutes of non-use, the unit goes into standby and will not produce ice until either 12 hours has elapsed or ice or water has dispensed.
Making ice	Green	Gearmotor, compressor, and fan motor energized.
Low bin	Green	Bin switch closed calling for ice.
Power on	Green	Power supplied to unit.

Water Feed Schematic

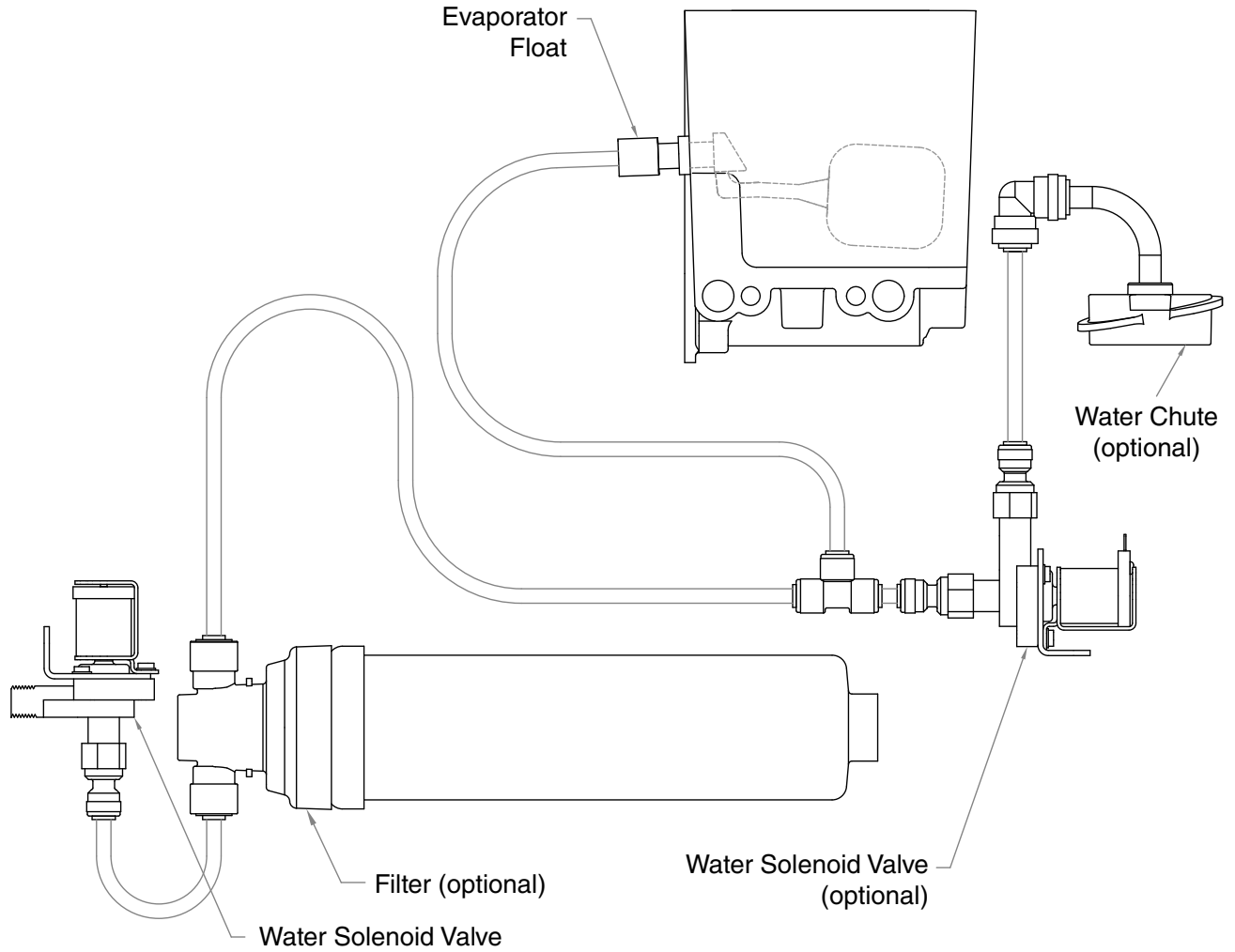

### Bin Melt Water/Evaporator Feed/Clean Out System Schematic

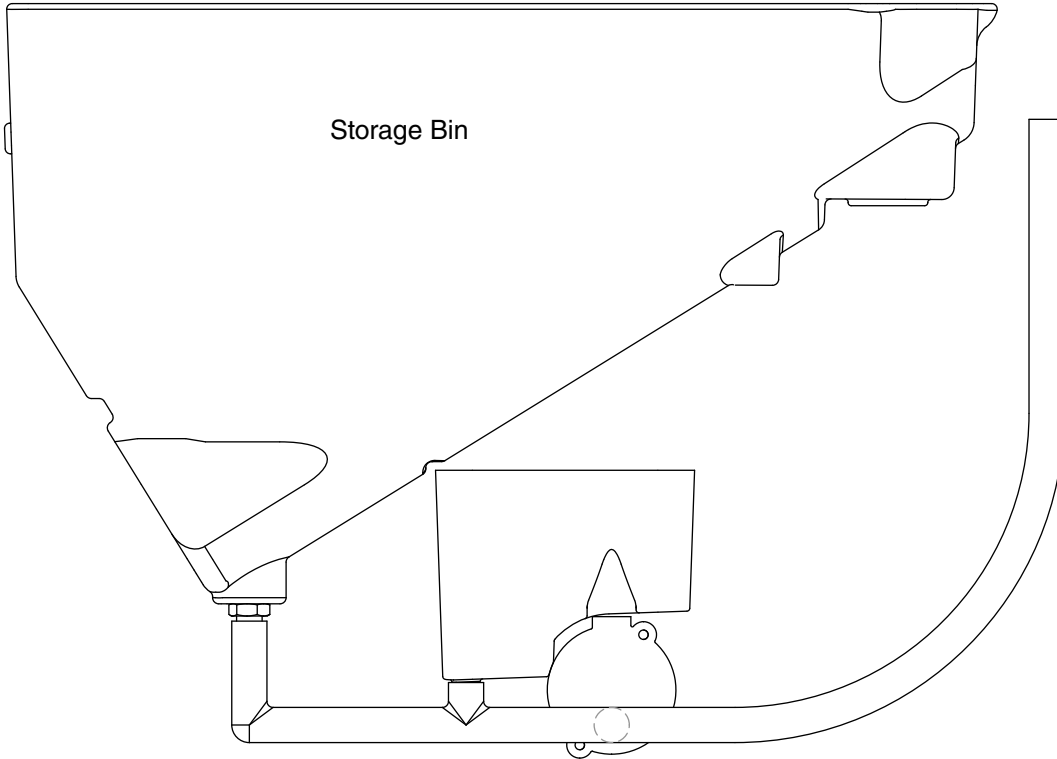

### Vent System Schematic

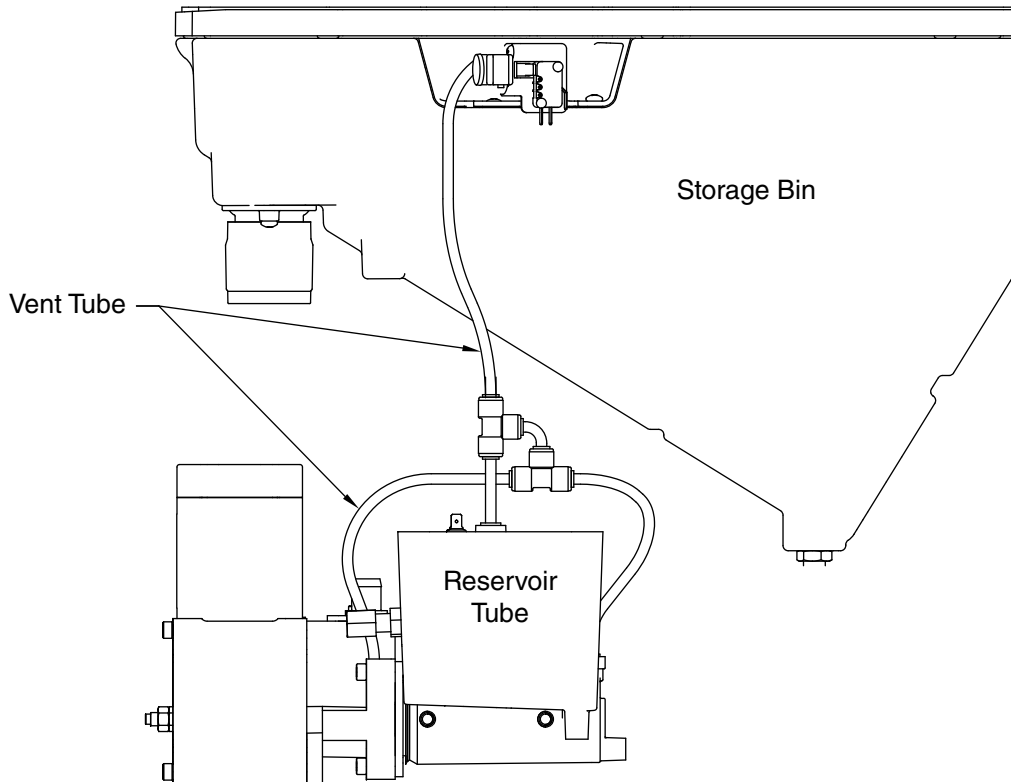





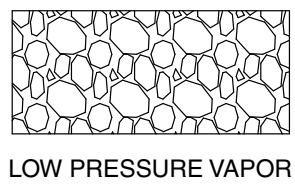
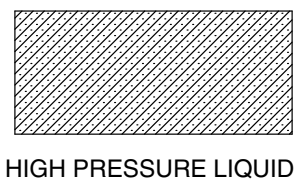
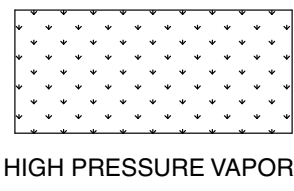
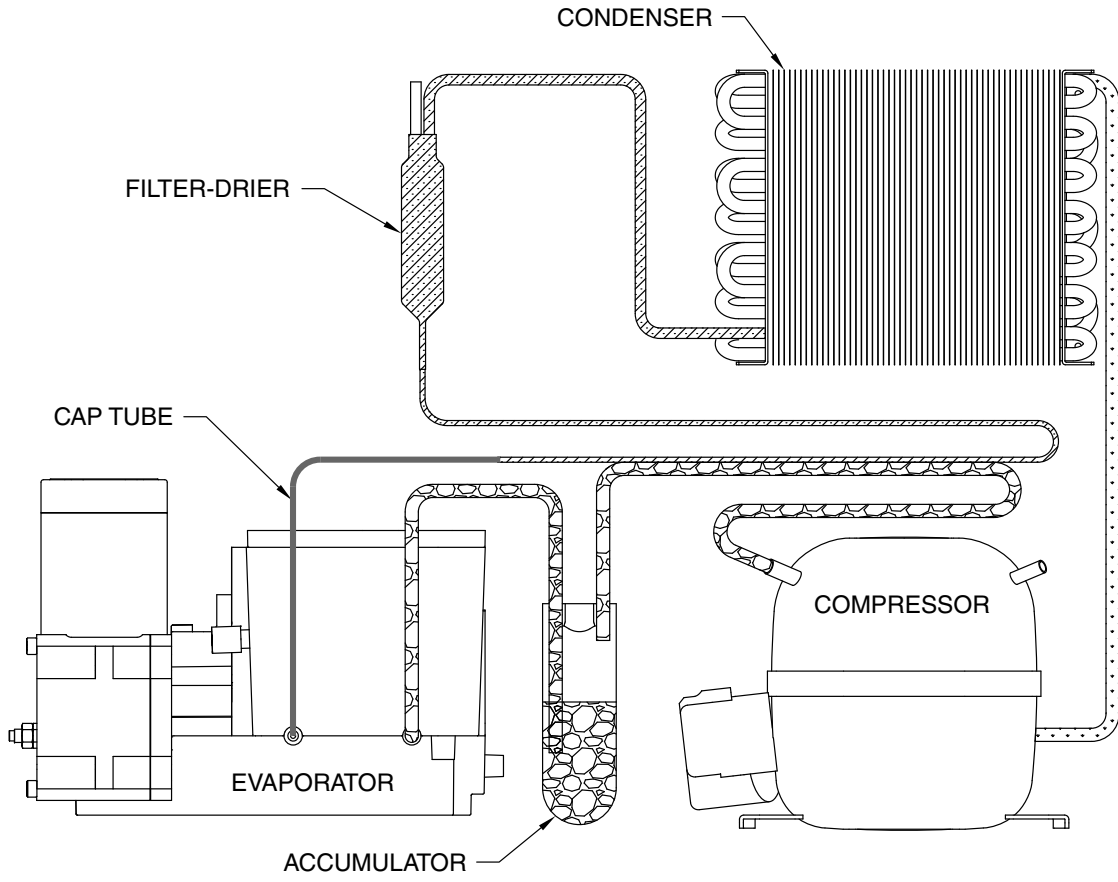

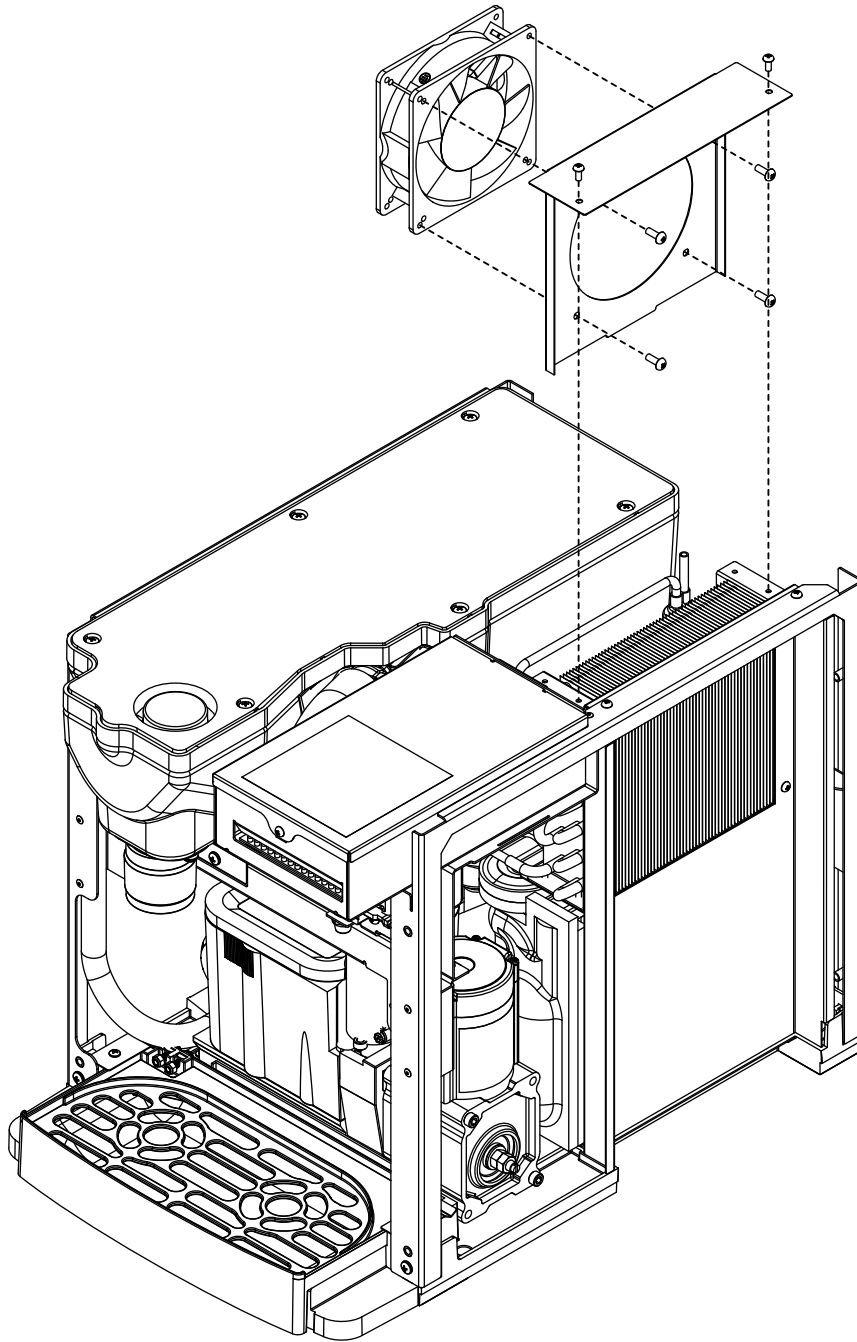

### Refrigeration Schematic





## Condenser Fan Motor Removal

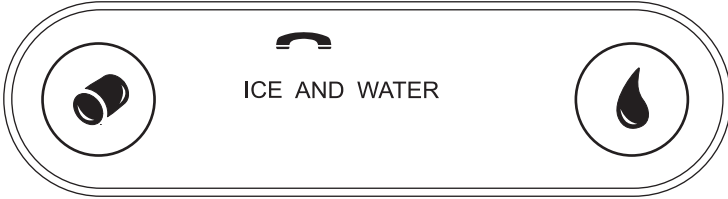
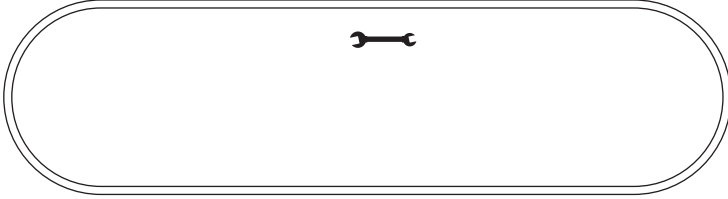

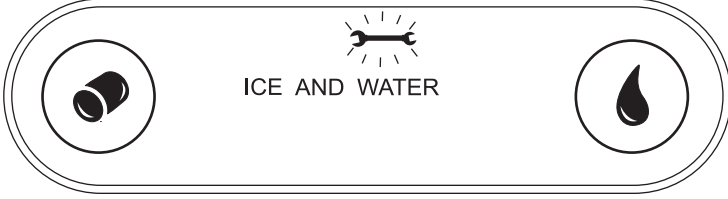
User Interface Display Identification

Operation Display	Condition	Procedure
	Normal operation	—
	Cleaning Mode	Press and release maintenance/clean switch to clean the user interface without dispensing ice or water (see <a href="#">Maintenance/Cleaning Mode on page 11</a> ).
	Drip tray full	Empty drip tray.
	Six-month periodic maintenance required	Follow Maintenance Mode procedure (below) and also see <a href="#">Cleaning and Sanitizing on page 13</a> .
	Maintenance Mode	Enter Maintenance Mode by pressing maintenance/clean switch until  displays. Complete the cleaning and sanitizing procedure shown on <a href="#">page 13</a> and change the filter, if so equipped. Exit Maintenance Mode by pressing and holding maintenance/clean switch until  no longer displays.
	Service - 8000 hr bushing check	Call Follett Technical Service Group at (877) 612-5086 or +1 (610) 252-7301. The flashing wrench indicates that the 8000 hr bushing check is required.

**Service** (continued)

Service Display	Condition	Procedure
	High amps	Contact Follett technical service group at (877) 612-5086 or +1 (610) 252-7301.
	Internal leak in dispenser	Locate leak and repair - Press reset on control board. Contact Follett if icemaker is leaking.

Electrical Wiring Diagram

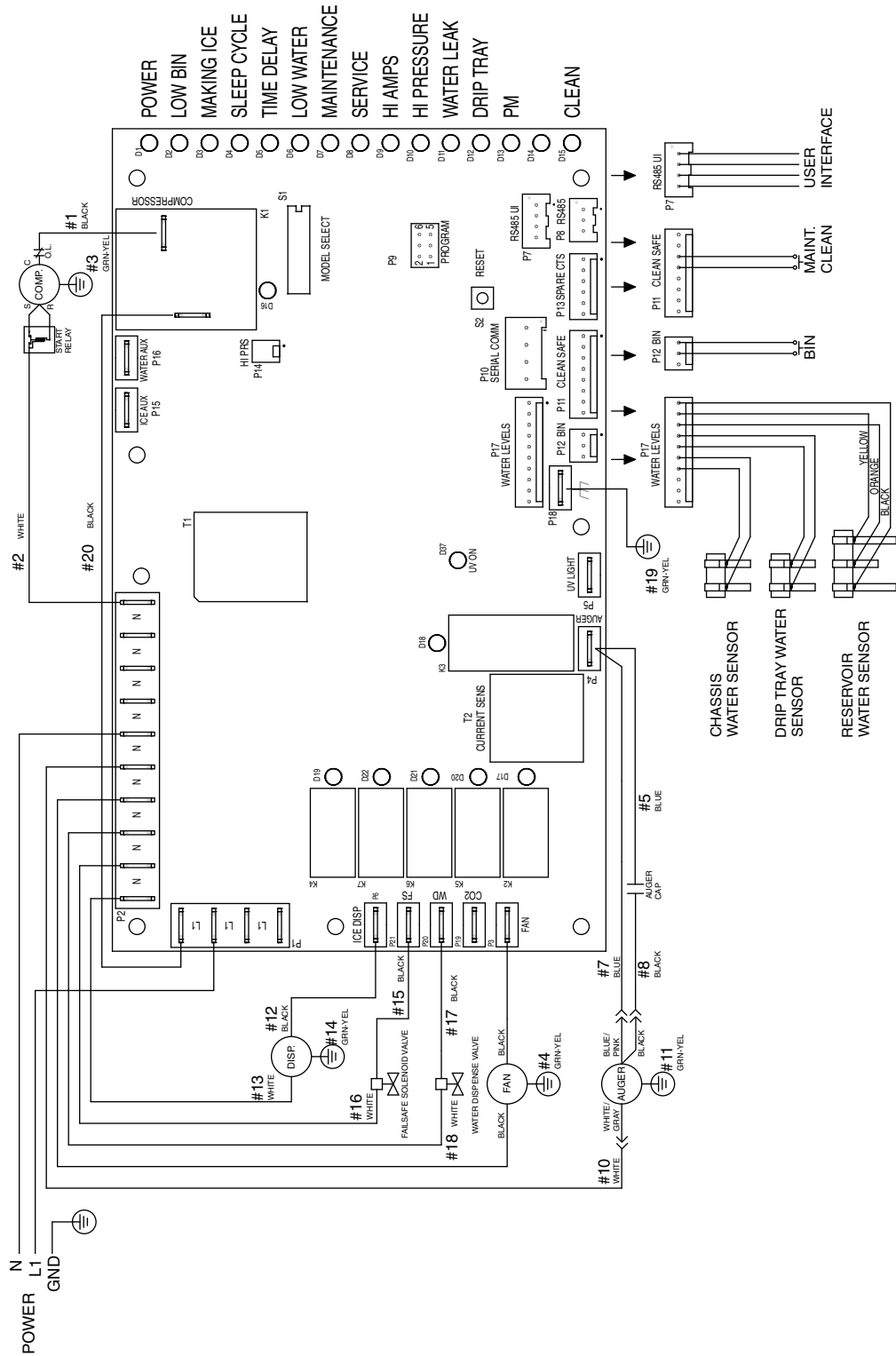

# Parts

## Exterior

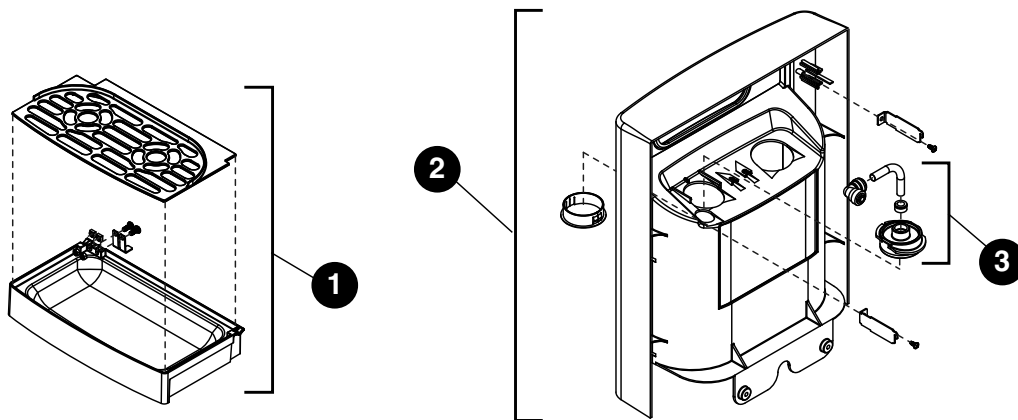
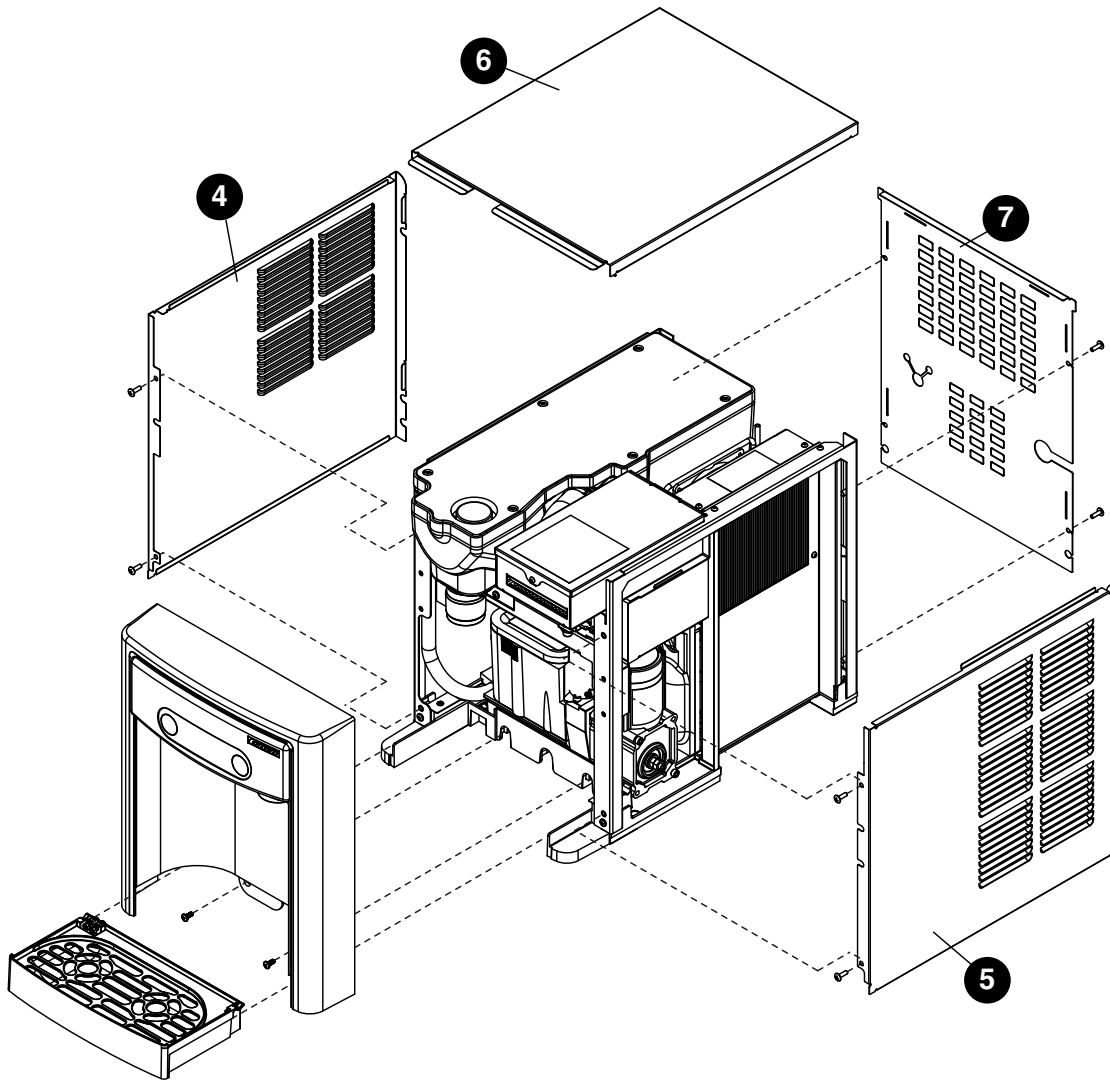

## Parts (continued)

---

### Exterior

Reference #	Description	Part #
1	Drip Tray Assy	00957613
2	Panel, Front Assy - Includes Water Nozzle and Plug	00957621
3	Chute, Water (water option)	00957688
4	Panel, Left	00957639
5	Panel, Right	00957647
6	Panel, Top	00957654
7	Panel, Rear	00957662
Not Shown	Cord, 115 VAC	00958058
Not Shown	Packaging for Returns, Dispenser	00957993
Not Shown	Fitting, Elbow - 1/4" FPT x 1/4" Tube	00974261
Not Shown	Drip Tray Drain Kit	00956375

Interior

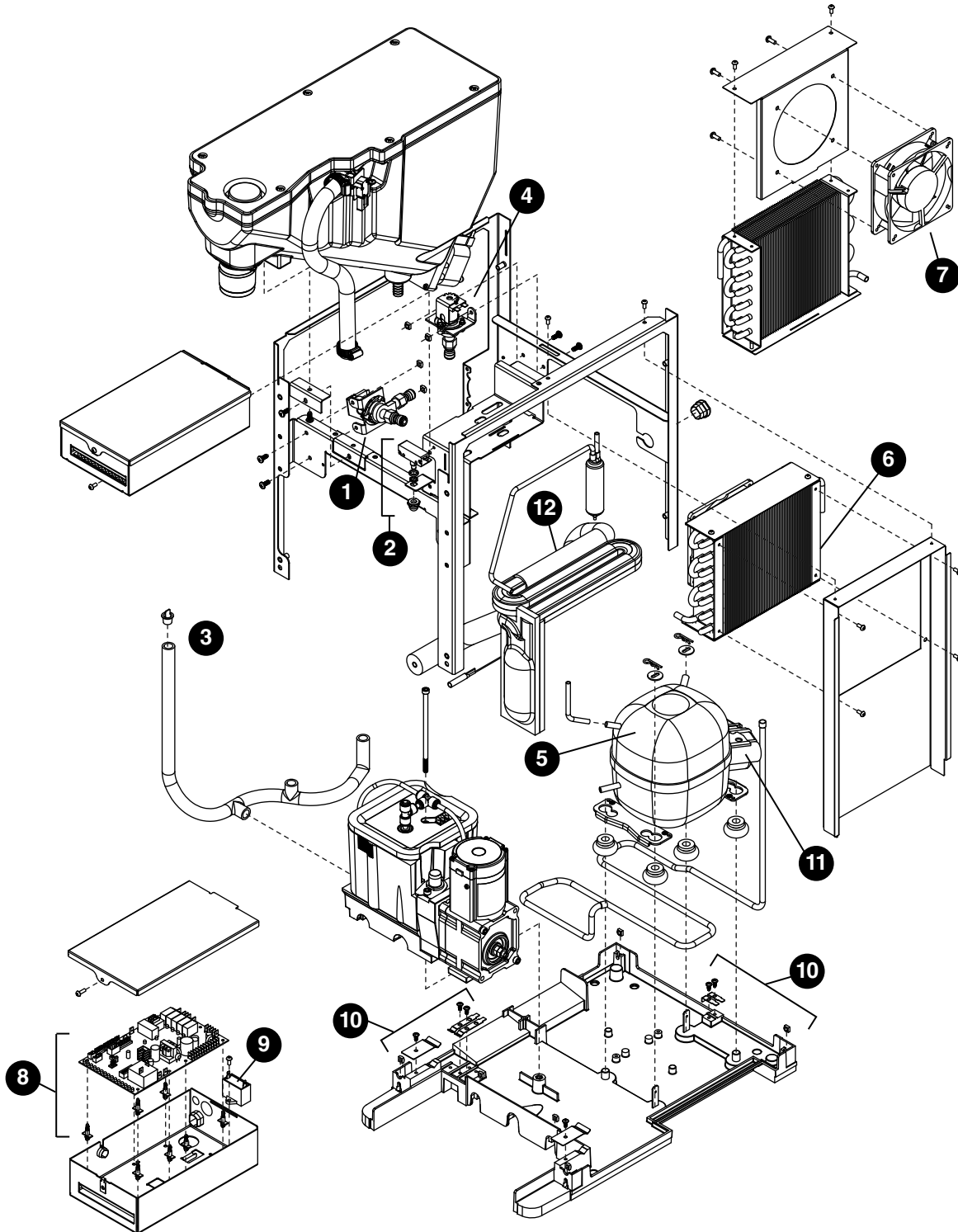



## Parts (continued)

---

### Interior

Reference #	Description	Part #
1	Valve, Dispense Solenoid (water option)	00957704
2	Switch, Cleaning	00957712
3	Drain/Feed Tube with Cap	00957720
4	Valve, Failsafe Solenoid	00957738
5	Compressor with Mounting Hardware	00958009
6	Condenser	00958017
7	Condenser Fan and Cord	00958025
8	Control Board with Stand-offs	00958033
9	Capacitor, Gearmotor	00958041
10	Sensor, Retainer Hardware Kit	00958066
11	Relay and Overload	00958090
12	Refrigeration, Piping Assy	00958132

Bin Assembly

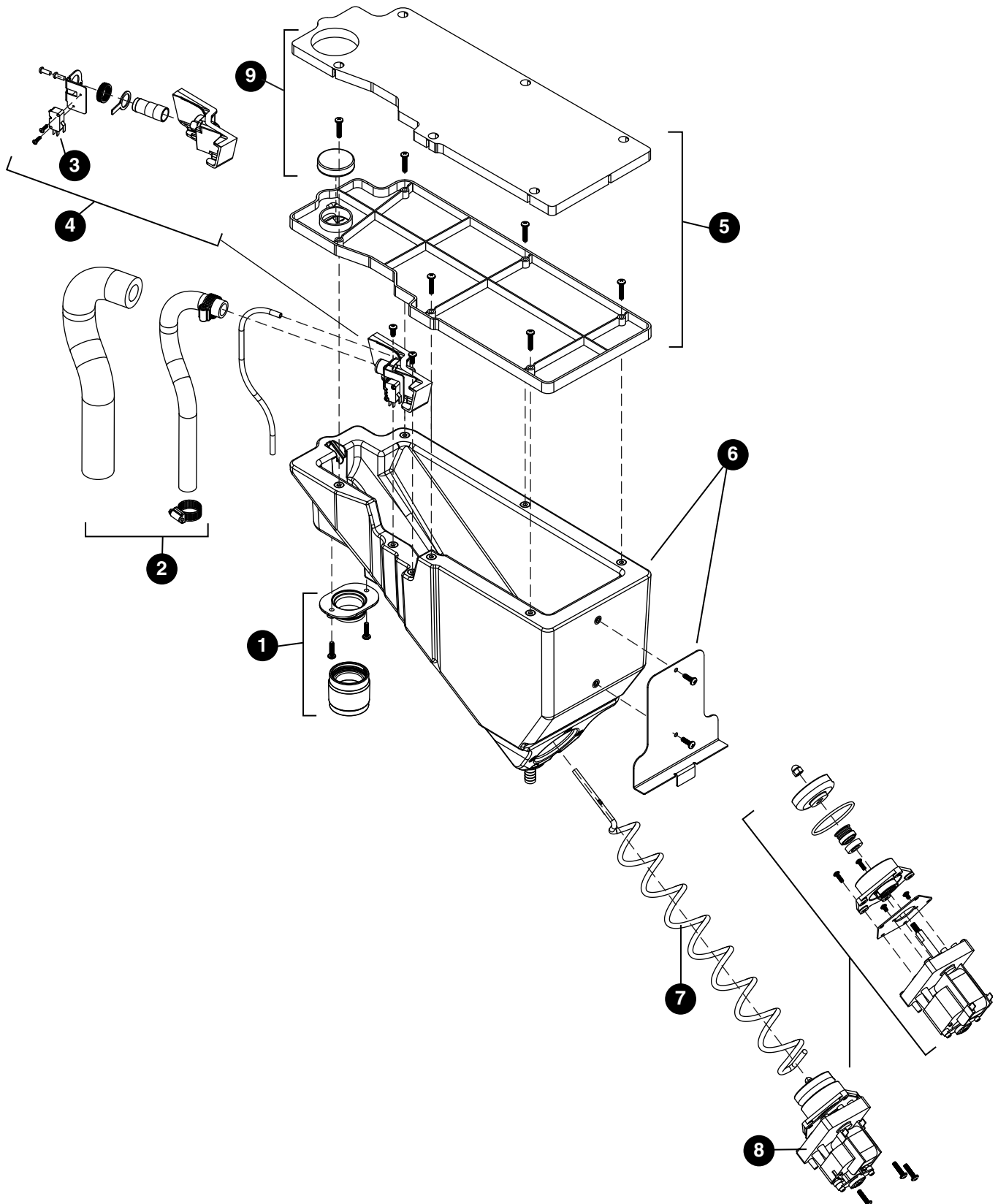

**Parts** (continued)**Bin Assembly**

Reference #	Description	Part #
1	Ice Chute Assembly	00957670
2	Ice Transport Tubing with Insulation	00957746
3	Switch, Shuttle	00957753
4	Shuttle, Complete Assy	00957761
5	Lid, Bin Assy	00957779
6	Bin, Assy	00957787
7	Auger, Dispense	00957795
8	Motor, Dispense	00957803
9	Cap and Insulation, Bin	00957936
Not Shown	For serial numbers D17619 and below:	
	Bin Cap	00931519
	Ice Chute	00927210
	Chute Adapter	00926550

Evaporator Assembly

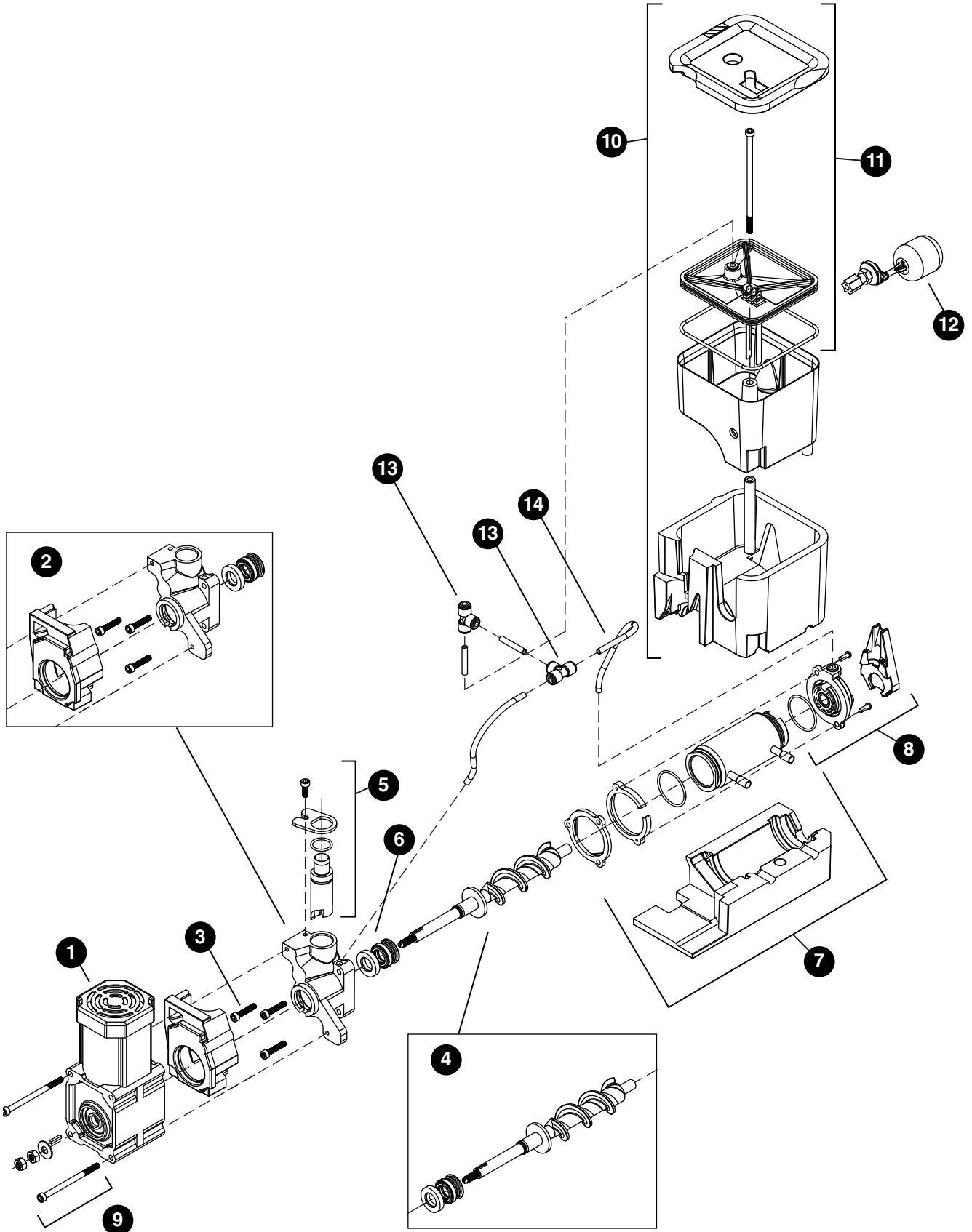

**Parts** (continued)**Evaporator Assembly**

Reference #	Description	Part #
1	Gearmotor	00957811
2	Main Housing with Front Seal and Screws	00957829
3	Screws, Main Housing	00957837
4	Auger with front seal	00957845
5	Ice Compression Nozzle Assy	00957852
6	Front Seal and O-Ring	00957860
7	Evaporator Assembly with Insulation	00957878
8	Housing, Bushing with Insulation	00957886
9	Hardware kit, Gearmotor	00957894
10	Reservoir and Float Complete Assy	00957902
11	Lid, Reservoir with Insulation and O-Ring	00957910
12	Float Valve	00957928
13	"T" Fitting - 1/4"	502923
14	Tubing - 1/4" (sold in 12" increments)	502079

Base Stand

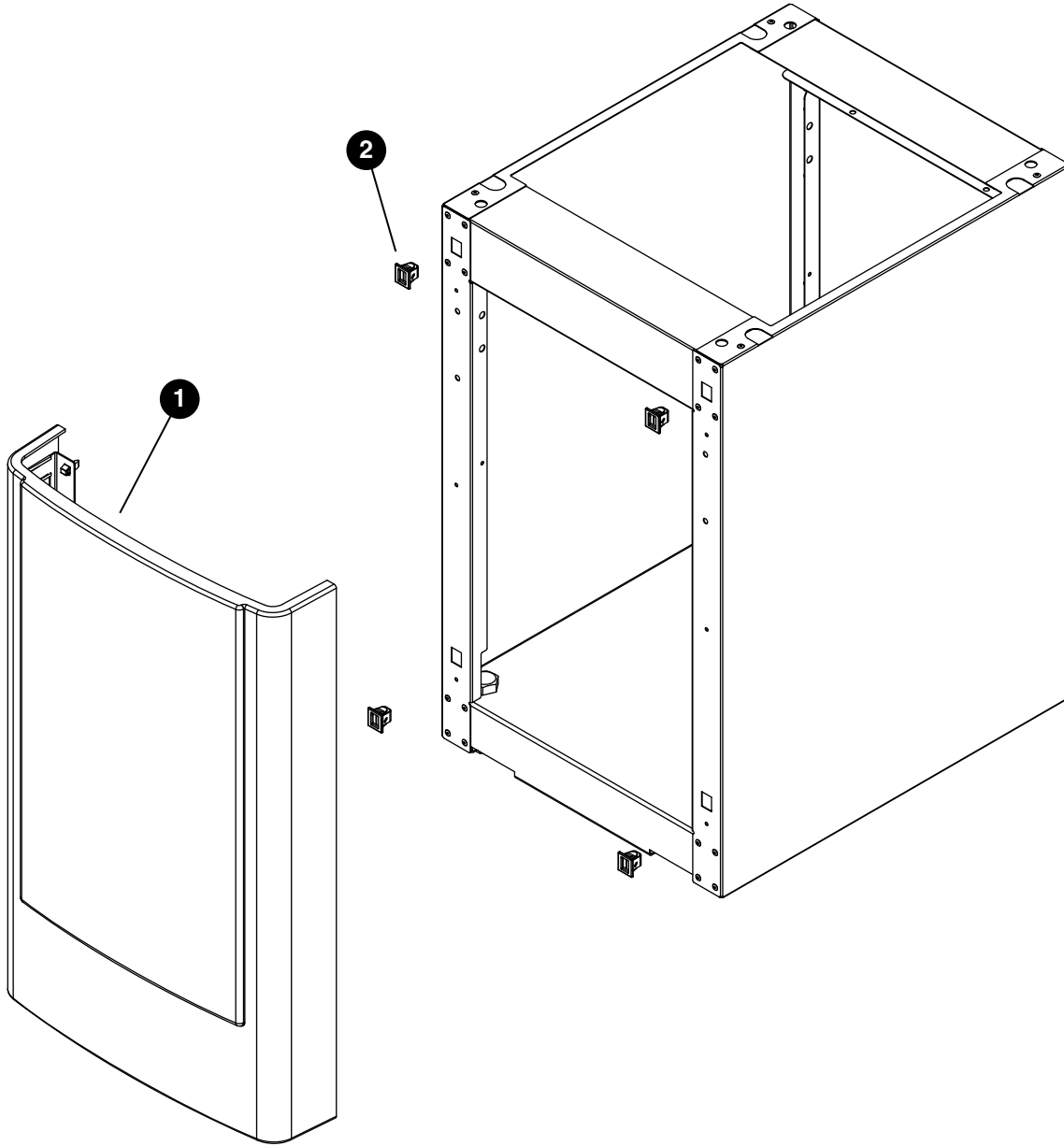

## Parts (continued)

---

### Base Stand

Reference #	Description	Part #
1	Front Panel, Base	00958108
2	Latches with Bayonets, Base	00958116
Not Shown	Tray, Base	00958124
Not Shown	Packaging for Returns, Base	00957985

### Miscellaneous

Reference #	Description	Part #
Not Shown	Internal water filter option	00958223
Not Shown	Water filter cartridge, 5 micron	00968107
Not Shown	Manifold, filter head	00968115
Not Shown	Cleaning and sanitizing kit, single use	00979856
Not Shown	SafeClean, case of 24	00132001
Not Shown	IMS II sanitizer concentrate, 16 oz	00979674
Not Shown	6" Legs for base stand, set of 4	00956318
Not Shown	4" Legs for countertop dispenser, set of 4	00956300
Not Shown	Kit, add water option	00957944
Not Shown	Kit, delete water option	00957951

SafeCLEAN and SensorSAFE are trademarks of Follett Corporation.

Chewblet and Follett are registered trademarks, and Horizon is a trademark of Follett Corporation, registered in US.



801 Church Lane • Easton, PA 18040, USA  
Toll free (877) 612-5086 • +1 (610) 252-7301  
[www.follettice.com](http://www.follettice.com)



00951640R03  
08/11